

Guarantee

TERMS AND CONDITIONS

The greatest care and technical expertise has been taken in the manufacturing of our ZODIAC® automatic pool cleaners.

Unless otherwise stipulated, we contractually guarantee the correct operation of our new Products. We guarantee that our Products conform to their technical specifications and that they are free of material and manufacturing default.

The present warranty is limited, at our discretion, either to the repair or exchange for a new or repacked product.

All Product returns must first be approved and decided by our services. Returns sent by your Retailer without our prior approval will not be accepted.

In particular, the spare parts warranty will only be honoured after analysis and inspection of the returned spare parts by our company who then, will make a decision to replace said parts.

In all cases the seller's legal warranty will continue to apply.

We introduce improvements and/or modifications to our products on a regular basis in keeping to keep abreast of technological progress. It is not possible for us to add such improvements to our previous models as part of this warranty.

Any requests concerning the warranty must be made to your retailer.

THE WARRANTY WILL NOT APPLY IN ANY OF THE FOLLOWING CASES

- Accidents, crushing, deterioration and damage due to shock and/or external causes or to causes unrelated to the damage observed
- If the device has been tampered with by a person unrelated to our workshop or a by a technician who is not approved by us, or if modifications have been made without prior written consent from us
- If the device has been damaged as a result of mishandling by the user or due to usage that does not conform to the user's manual that is included with the product
- If the device, its components, and/or the hose sections are exposed for an extended period of time to direct sunlight
- If the device, its components, and/or the hose sections have been damaged due to chemical imbalance of the pool water.

In order to benefit from the warranty, the End User agrees to respect the following parameters concerning the water balance of the swimming pool:

- pH: 6.8 < pH < 7.6
 - free chlorine (*): < 3,0 mg/L
 - total bromine (*): < 5.0 mg/L
 - stabilising agent (if used): < 75 mg/L
 - total dissolved metals (iron, manganese, copper, zinc...): < 0.1 mg/L
- (*): It is imperative that swimming pool cleaners be removed from the pool before using a shock treatment.

Note: Using water drawn from a well is forbidden.

- The present warranty does not apply to visible defects that the retailer failed to report upon accepting delivery of the Products.
- Also excluded from the warranty are: defects or deterioration due to the unsuitability of the Product with respect to the End User's needs, due to normal wear, to negligence, to incorrect installation, also to a use that does not conform to the recommendations mentioned in the User Manual, to a lack of maintenance and/or a handling accident, to incorrect storage, and/or to tests, instructions and/or specifications made by your Retailer
- Any modifications made by the Client, by the End User or by any third party to our Products will automatically void the warranty in full. The same will apply if original parts were to be replaced with spare parts not sold by us.
- Your Retailer will be responsible for ensuring compatibility of our Products with any other pool equipment it may be installed with, by checking with the different manufacturers concerned, also for ensuring that all installation and operating instructions and rules are respected in order for the overall system to operate correctly.

PERIOD COVERED BY THE WARRANTY

The warranty will cover a period of 2 years for the Zodiac® MX™ 8 robot cleaner.

The effective warranty start date is the date mentioned on the sales invoice for the new Product as issued by the Retailer to the End User.

This document will be required as proof of purchase in order for the warranty to be effective. Failing this, the Retailer shall bear the full cost of any claims made by the end User under the contractual warranty and after its expiry date.

Under no circumstances shall any repairs or replacements carried out under the terms of this warranty cause its duration to be extended or renewed.

SCOPE OF THE WARRANTY

- During the period covered by the warranty as stipulated above, any part that has been acknowledged as being defective will be repaired or replaced by the manufacturer with a new or fully functional part. This warranty applies to any conformity defects potentially present at the time of delivery of the product.
- In the case of a return of the product, shipping expenses to our workshop will be borne by the end user.
- Shipping expenses for the new or repaired Product delivered to the retailer will be borne by us, excluding any labour costs, travel and/or accommodation expenses incurred as the result of repairs made outside of continental France and excluding any payment of damages.
- Immobilisation and deprivation of use of an appliance due to repair will not give the right to compensation.

THIS WARRANTY IS CONSIDERED VALID SUBJECT TO THE INTRODUCTION OF NEW LEGAL REQUIREMENTS NOT YET PUBLISHED AT THE TIME OF THE DRAWING UP OF THE PRESENT CONDITIONS.

DAMAGES DURING TRANSPORTATION

Our products are always shipped at the users' risk. Before accepting delivery of the products, users should ensure that these are in perfect condition. We will not be held responsible for any damages incurred during transportation.

CAUTION CONCERNING USE IN A VINYL LINER POOL

Certain vinyl liner patterns are particularly susceptible to rapid surface wear or pattern removal caused by objects rubbing on the vinyl surface, such as pool brushes, pool toys, floats, fountains, chlorine dispensers, and automatic pool cleaners. Some vinyl liner patterns can be seriously scratched or abraded simply by rubbing the surface with a pool brush. Ink used for the printed patterns may also rub off during installation or when in contact with objects in the pool. Zodiac® will not be responsible for damages to printed patterns, abrasion or markings on vinyl liners, and the Limited Warranty will not cover these points.

Zodiac® will not be held responsible for any damage to the swimming pool lining (vinyl liner, reinforced PVC, etc.) occurring as the result of an excessive level of disinfectant (chlorine, bromine, active oxygen, etc.) or an incorrect pH value. Any such damages will be not be covered by the warranty.

DO NOT RESTRICT THE SUCTION , FAILURE TO HEED THIS WARNING MAY RESULT IN A RISK OF SERIOUS INJURY AND POSSIBLY DEATH.

Do NOT block the suction inlet or suction parts with any part of your body. Do not expose your hair, clothes, jewellery, etc. to the suction inlet and suction components of the pool/spa.

For further information please contact your retailer.

Register your product on our internet website:

- Be the first to be informed of our latest product innovations and promotions.
- Help us continuously improve the quality of our products.

www.zodiac-poolcare.com

Introduction

Congratulations on the purchase of your new Zodiac® MX™ 8 automatic pool cleaner. Manufactured using proven Zodiac® technology, the Zodiac® MX™ 8 is designed and manufactured for easy installation, and years of carefree operation. Before installing the cleaner, please take a few moments to become familiar with its components and to review the items listed under Important Information.

Like most mechanical devices, the Zodiac® MX™ 8 requires periodic adjustments, routine maintenance, and the replacement of certain hardworking parts. Be sure to have the Zodiac® MX™ 8 checked occasionally by your local Zodiac® dealer.

Always insist on genuine Zodiac® replacement parts. Non-Zodiac® parts are not made to our specifications. They may have an adverse effect on the operation of your Zodiac® MX™ 8 or may even damage it.

Remark: If your pool is fitted with a variable speed filtration pump it is essential that you set it to its maximum power when using your hydraulic suction cleaner in order to ensure an optimal operating flow. If necessary use the flow tester supplied with the cleaner.

Zodiac® MX™ 8 Complete Cleaner

1. Cleaner Body
2. Automatic Flow Adjustment™ Valve
3. Valve Cuff
4. Twist-Lock 45 Degree Elbow Extended
5. Flow Gauge
6. Quick Connector
7. Hose Float
8. 45 Degree Elbow
9. Twist-Lock Hose Section (12 x 1 m)

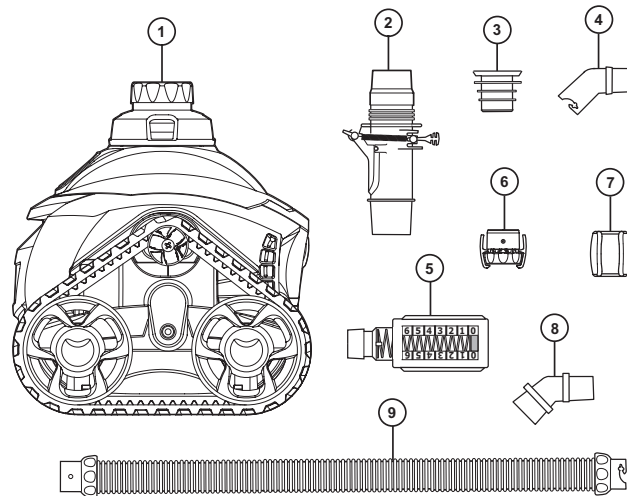

Read owner's manual completely before operating the cleaner.



Do not operate outside of the pool.



Remove cleaner before entering the pool.



Do not let children play with cleaner.

Installation

Prepare the Pool

1. Manually vacuum the pool, and make sure the pool filter and pump basket are clean.
2. Close the pool main drain line.
3. Aim the return line fittings downwards.

Assemble the Hose

The hose uses easy twist-lock connectors. Push and twist the connector on each hose section until they lock into position with a clicking sound. The hose cuffs have 3 connection positions. Any of the 3 positions are sufficient for an air-tight seal.

1. Connect enough hoses to reach the farthest point from the skimmer or vacuum point you are using and then add one more section of hose. If your pool length is greater than 11 m, you can purchase additional hoses. Contact your retailer.
2. Place the quick connector at the end of the first hose section which has the float on it. Ensure that the float is positioned at a distance of 23 cm from the quick connector.
3. Connect the first hose section with the float to the robot.

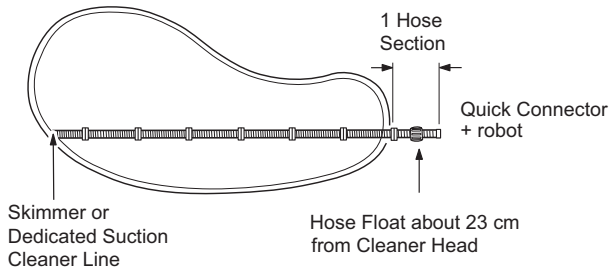
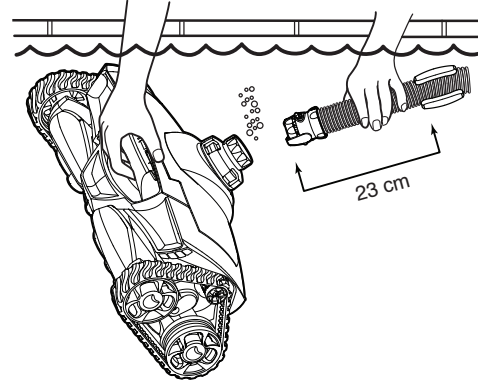

free form

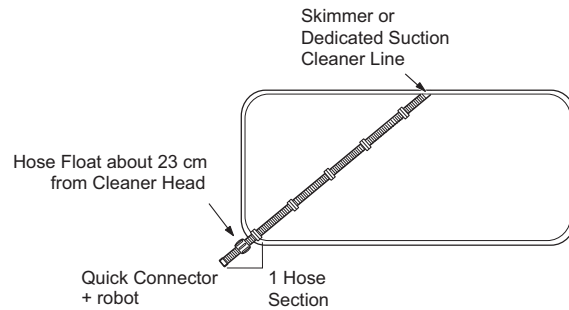

rectangular

Connect the Hose

Turn on the filtration system and fill the hose with water by placing the end in front of a return inlet until it is full of water. Turn off the pump.

To connect to a dedicated suction line or vacuum point:

1. Twist lock the male end of the hose into the large end of the 45° elbow.
2. Connect the elbow to the valve cuff and to the dedicated suction inlet.
3. Angle the elbow upward towards the water surface.

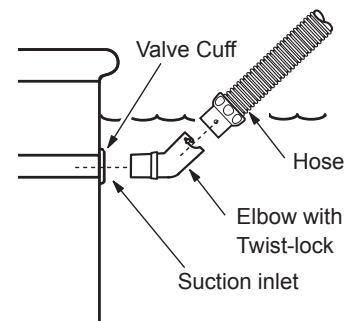

To connect to a skimmer:

The Automatic Flow Adjustment™ valve must always be used in single skimmer installations.

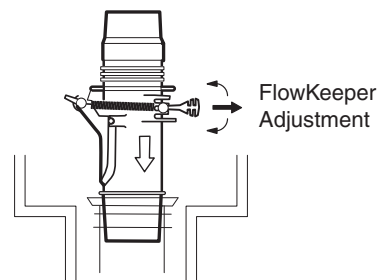

The valve regulates flow to ensure the pool pump and cleaner run properly. It is pre-set at the factory to optimize the performance of the cleaner, but offers three settings to adjust the flow.

The lower the setting number, the lower the flow. To adjust, pull the handle and move setting up or down. The red tab can be used to open the valve and stop the cleaner.

If the pool has more than one skimmer, connect the hose to the one closest to the pump.

The parts used to connect the hose, and the sequence in which they are installed depends on the type of skimmer. Choose the fitting combination that best suits the skimmer to complete the connection.

1. Remove the skimmer basket.
2. Connect the Automatic Flow Adjustment Valve with the valve cuff and the 45° Elbow. Then, connect this complete assembly with the arrow pointing down towards the skimmer pipe. Connect the assembly of hoses.

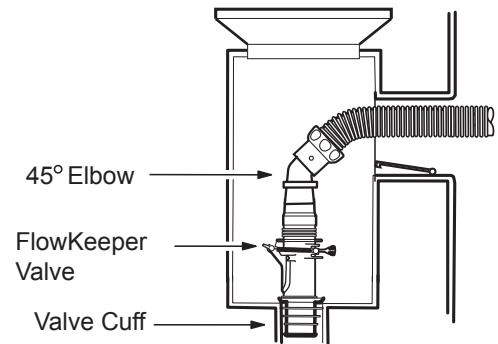

Test and Adjust for Proper Flow

Disconnect the cleaner head and attach the Flow Tester. Keep the Flow Tester under water and have someone turn on the pump.

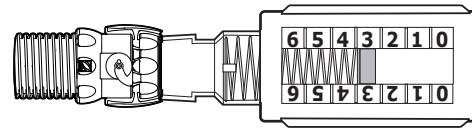

Verify that the red indicator in the Flow Tester (viewed from the side) is at the Number 3 setting. All these operations must be carried out under water so that the pump does not take in air.

If necessary, use the valves in the pool equipment area to adjust the flow.

- **For skimmer connections on pools with one skimmer**, flow is automatically regulated by the Automatic Flow Adjustm^{tr}™ Valve. The red indicator should be at the proper setting.
- **For skimmer connections on pools with more than one skimmer**, leave the valve for the skimmer connected to the hose open and slowly close the other until the proper setting is reached.
- **For dedicated suction line connections**, leave the vacuum line open to the cleaner and slowly close the skimmer line until the flow is at the proper setting.

If flow is in the low range (0-2):

- Check and clean the pool filter and baskets if necessary.
- Verify that valves controlling the suction lines are in the correct position.

If flow is in the high range (4-6):

- Verify that valves controlling the suction lines are in the correct position.
- Lower the flow setting on the Flow Adjustment Valve. The automatic flow adjustment valve is pre-set in the factory to number 3, the most suitable position for European pools. For an optimal performance from your cleaner, you could move the valve between first to third position.

Connect the Cleaner

WARNING

To avoid serious injury, make sure to turn off the suction pump for the cleaner.
Do not expose your hair, loose clothing, jewelry, etc. to the open end of the hose.

Turn off the pump. Keeping the hose underwater, remove the Flow Tester.

1. Submerge the cleaner and fill it with water.
2. When bubbles stop coming from the cleaner, connect the hose by pushing the Quick Connector into the cleaner.
3. Allow the cleaner to sink to the bottom of the pool.
4. Turn on the pool pump and begin cleaning.

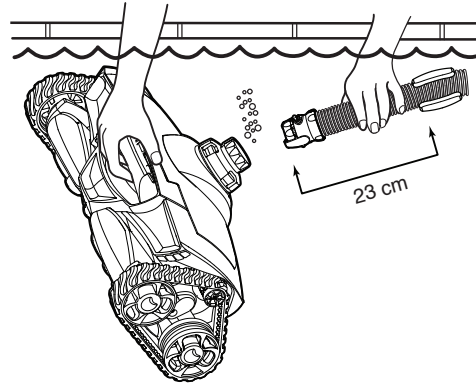

Operation and Routine Maintenance

The Zodiac® MX™ 8 switches on/off with the pool filtration pump, vacuuming and cleaning all surfaces randomly throughout the pool. The climbing ability of the cleaner is dependent on the pool's shape and available water flow. If Zodiac® MX™ 8 is not climbing your walls, ensure the flow is correct by using the Flow Tester. Also, ensure the pool's surface is not covered with algae as this slippery surface will affect the cleaner's traction.

During each cleaning cycle, the cleaner travels both forward and backwards, and pivots to the right and left. The power scrubbers underneath the cleaner create a downwards force for climbing and stability as well as directing debris into the cleaner mouth.

Emptying the Pump Basket

For the Zodiac® MX™ 8 to operate at optimum efficiency, empty the pump basket regularly. The more debris in the pool, the more often the pump basket should be cleared. Zodiac® offers an in-line leaf basket which will stop solid debris before it enters the pump basket. See your Zodiac® dealer for details.

Backwashing the Pool Filter

Always disconnect the Zodiac® MX™ 8 from the pool wall before cleaning or backwashing the pool filter. After cleaning or backwashing, let the filtration system run for at least five minutes to flush out the suction lines before re-connecting the cleaner.

Adding Chemicals to the Pool

Remove the cleaner from the pool for at least 4 hours when adding chemicals.

Storage and Winterizing

Never store the Zodiac® MX™ 8 in direct sunlight. When storing for the winter, drain all the water from the cleaner (freeze damage is not covered by the warranty). Remove all connectors and adapters from the dedicated suction line/vacuum point or skimmer. When storing the cleaner, even for short periods, do not coil the hose as the hose may develop a memory which can affect cleaner performance. Disassemble the hoses and lay them flat and straight.

Removing Debris from the Drive Motor

WARNING

To avoid serious injury, make sure that the cleaner is disconnected from the hose and that the suction pump used for the cleaner is turned off prior to starting the following operation.

- 1) Push the latch release button on the top of the cleaner.
- 2) Rotate the top assembly back until it clicks into an upward position.
- 3) Look in the drive motor and remove debris that is present.
- 4) If needed, slowly push drive motor paddles forward and/or backwards to move debris that is stuck to an accessible position then remove it. When moving the paddles, make sure the cleaner tracks are allowed to move freely as they will turn as the drive motor paddles rotate.
- 5) Close the top of the drive motor and ensure the latch clicks in place.

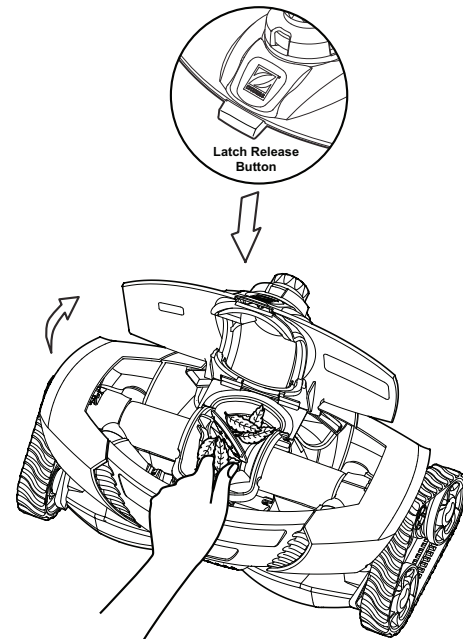

Cleaner Vacuum Modes

The Zodiac® MX™ 8 Pool Cleaner is designed with 2 vacuum options:

1. **Small debris cleaning mode:** For vacuuming smaller and heavy debris, such as, sand, silt and small stones. The pool cleaner is sent from the factory in this mode.
2. **Large debris cleaning mode:** For vacuuming large debris, such as, leaves.

WARNING

To avoid serious injury, make sure that the cleaner is disconnected from the hose and the suction pump used for the cleaner is turned off prior to starting this operation.

To convert the pool cleaner to the large debris cleaning mode:

1. Grasp the yellow inlet adapter and insert a finger into the adapter hole, as shown below.
2. Lift up the rear edge of the inlet adapter and then pull it out of the vacuum inlet.

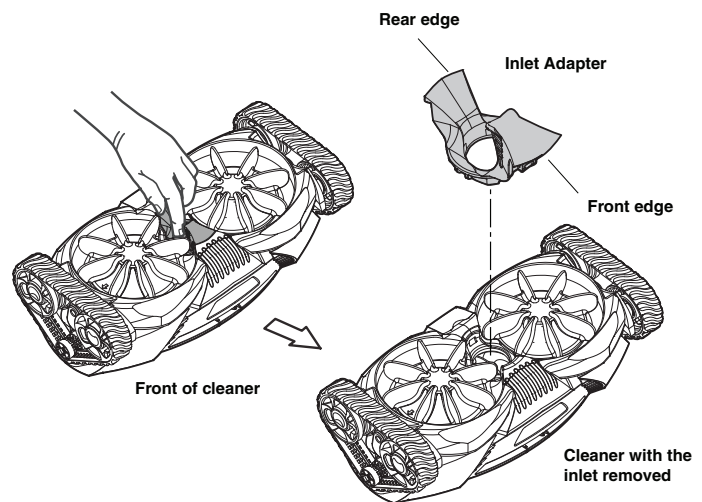

To convert the cleaner back to the small debris cleaning mode (original from factory):

1. Place the yellow inlet adapter in the vacuum inlet of the pool cleaner. Push down on the yellow inlet adapter until both the front and rear edges click into place.

Troubleshooting

If you experience a problem with your Zodiac® MX™ 8, please follow the troubleshooting steps below to rectify any performance problems. If further assistance is required, contact your retailer.

Problem	Solution
Cleaner does not move or moves slowly.	<ul style="list-style-type: none">• Confirm that the main drain is closed.• Use Flow Tester to verify correct flow.• Backwash filter and empty pump basket.• Check for debris trapped in the drive motor. See the section “Remove the debris from the motor”.• Remove the yello adaptor from the inlet mouth. See section “Cleaner vacuum modes”.• Check for air in system. If water level in pump basket drops or you see excessive air bubbles in the pump basket or coming from the return lines, there is air in the system. Check hose connections, tighten all fittings at pump and check o-ring at pump basket for wear.• Check that the cleaner is not clogged with debris.
Cleaner’s pattern of movement does not cover entire pool.	<ul style="list-style-type: none">• Use Flow Tester to verify correct flow.• Ensure return line fittings are directed downwards.• Make sure there are no kinks in the hoses and that they are not coiled. Lay in sun to straighten if necessary. Is your hose long enough: add hose sections if necessary.• Verify correct hose float positioning.• Observe cleaner for 5 plus minutes and ensure that each drive track is periodically reversing direction.• Confirm proper hose length.
Cleaner gets stuck at steps.	<ul style="list-style-type: none">• Observe cleaner for more than five minutes and ensure that each drive track is periodically reversing direction.• Ensure the swivel on top of the cleaner rotates freely.• Use Flow Tester to verify correct flow.• Confirm correct hose length. Shorten if necessary.
Cleaner won’t climb walls.	<ul style="list-style-type: none">• Using Flow Tester as guide, increase flow to cleaner.• Verify correct hose float positioning.
Cleaner spends too much time on the walls.	<ul style="list-style-type: none">• Using Flow Tester as guide, reduce flow to the second setting.• Verify correct hose float position.
Cleaner riding on its side.	<ul style="list-style-type: none">• Verify correct hose float position.

For further information please contact your retailer.

Zodiac® MX™ 8 Parts Diagram

EN

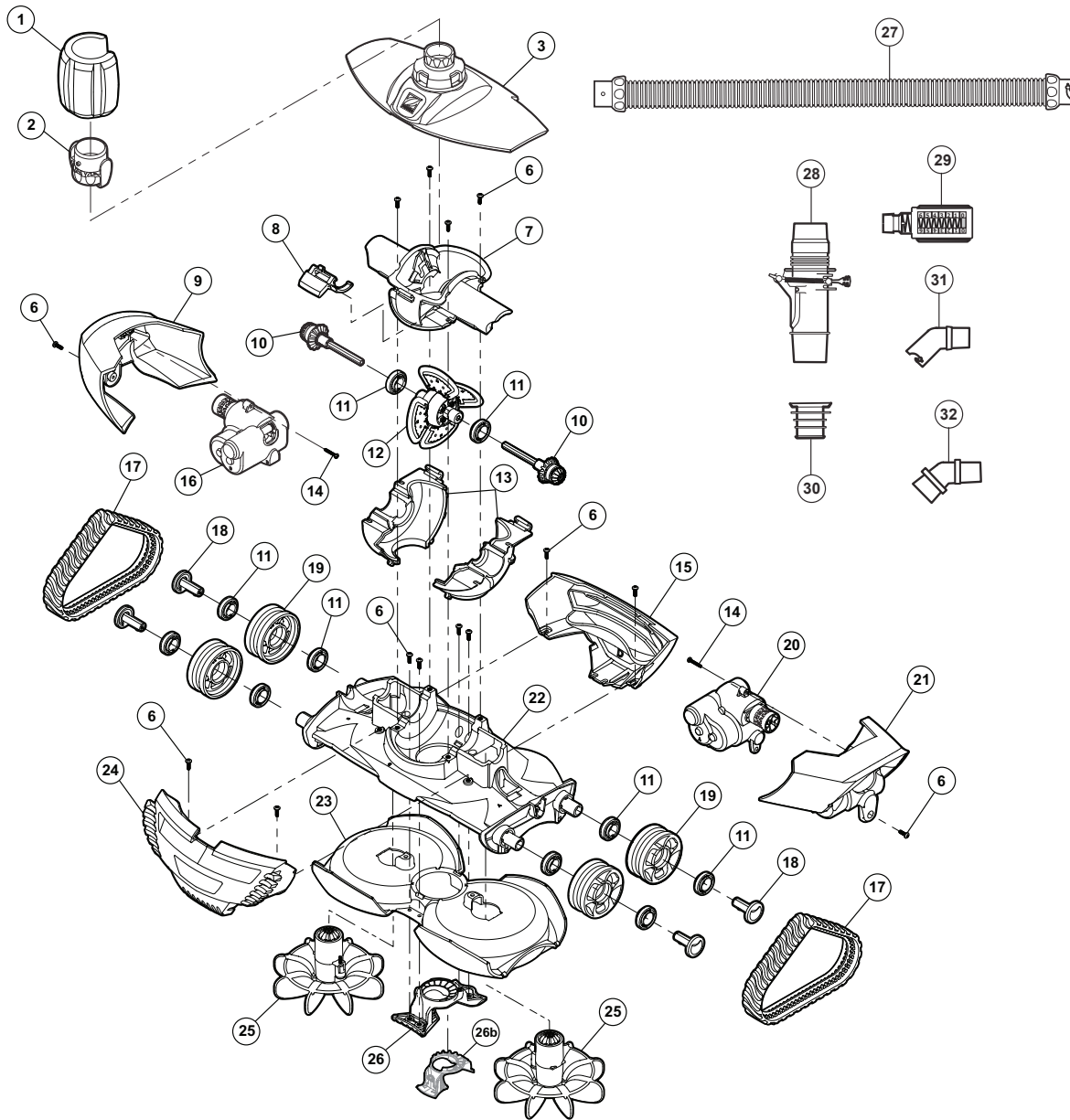

No.	Description	Qty.	No.	Description	Qty.
1	R-KIT, MX8 HOSE FLOAT	1	18	R-KIT, MX8 WHEEL PIN	4
2	R-KIT, CLIP-ON HOSE ADAPTOR	1	19	R-KIT, MX8 WHEEL	4
3	R-KIT, MX8 TOP COVER W/SWIVEL ASSEMBLY	1	20	R-KIT, MX8 REVERSING ASSEMBLY- SIDE A	1
6	R-KIT, SCREW, M4x12mm, PHILLIPS #2 PAN HEAD	16	21	R-KIT, MX8 BODY PANEL - LEFT (A)	1
7	R-KIT, MX8 MIDDLE DRIVE MOTOR HOUSING	1	22	R-KIT, MX8 CHASSIS ASSEMBLY	1
8	R-KIT, MX8 COVER LATCH	1	23	R-KIT, MX8 LOWER BODY HOUSING	1
9	R-KIT, MX8 BODY PANEL - RIGHT (B)	1	24	R-KIT, MX8 BODY PANEL - FRONT (C)	1
10	R-KIT, MX8 DRIVE SHAFT ASSEMBLY	2	25	R-KIT, MX8 SCRUBBER ASSEMBLY	2
11	R-KIT, BEARING, (WHEEL & ENGINE)	10	26	R-KIT, MX8 INLET ASSEMBLY	1
12	R-KIT, MX8 DRIVE MOTOR ASSEMBLY	1	26b	R-KIT, MX8 REGULAR OPENING	1
13	R-KIT, MX8 LOWER DRIVE MOTOR HOUSING- SIDE A & SIDE B	1	27	R-KIT, TWIST LOCK HOSE - 1 METER, BLUE/GRAY	12
14	R-KIT, SCREW, THREAD FORMING, #6-18 7/8in TYPE A, PHILLIPS #2 PAN HEAD	2	28	R-KIT, AUTOMATIC FLOW ADJUSTMENT VALVE	1
15	R-KIT, MX8 BODY PANEL - REAR (D)	1	29	R-KIT, FLOW TESTER	1
16	R-KIT, MX8 REVERSING ASSEMBLY- SIDE B	1	30	R-KIT, IN-GROUND VALVE CUFF	1
17	R-KIT, MX8 TRACK	2	31	R-KIT, TWIST-LOCK 45 DEG ELBOW, EXTENDED	1
			32	R-KIT, 45 DEG ELBOW	1